

Composite dry sliding bushings, metric dimensions

Principal dimensions			Basic load ratings		Mass	Designation
d	D	B	dynamic C	static C0		
mm			kN		kg	-
<b>12</b>	14	12	17,3	36	0,0028	PCM 121412 M

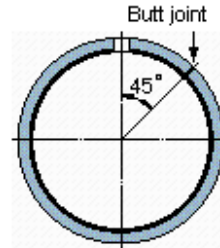
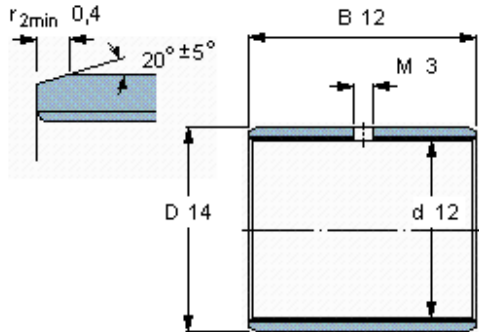

**Specific load factor** K 120  
**Material constant**  $K_M$  1900